



LED Slim Downlight - SDL Series



Application: family room, bedroom, hallway, corridor, or any other common area in your living space.

Feature

- The ultra slim LED downlights/surface mini panel comes with separate steel encased LED driver with watertight seal
- Backlit technology gives more even and brighter light distribution
- Airtight & Type IC Rated: No housing Required
- Snap-in mounting springs and easy wiring access for fast & easy Installation: Save labor cost.
- Junction Box Included: No additional hardware required.
- Damp location rated and dimmable with approved dimmers
- Body: Durable, die cast aluminum alloy for optimal heat dissipation
- White, Nickel or Black for choice--Scratch resistant and smooth finish

Specifications

Model	HY-SDL-R3-6W-5CCT	HY-SDL-R4-9W-5CCT	HY-SDL-S4-9W-5CCT	HY-SDL-R6-12W-5CCT	HY-SDL-S6-12W-5CCT	HY-SDL-R8-18W-5CCT
Size	3" Round	4" Round	4" Square	6" Round	6" Square	8" Round
Power	6W	9W		12W		18W
Input Voltage	120V AC					
Frequency	60Hz					50Hz/60Hz
Dimming	Triac dimmable					0-10V Dimmable
Lumen	80LM/W					85LM/W
Beam Angle	120°					
CCT	5CCT (2700K/3000K/3500K/4000K/5000K) Tunable					
CRI	>80					
Working Life	Lumen Maintenance over 70% @ 360000+ Hours					
Oper. Temperature	-4°F to 104°F (-20°C to 40°C)					
Certification	ETL/Energy Star					



LED Slim Downlight - SDL Series

DIMENSION

3" Round

4" Round

6" Round

8" Round

Front View

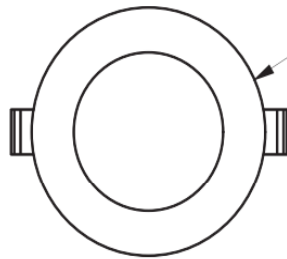

3"Size: $\phi 3.86"$ ($\phi 98\text{mm}$)
 4"Size: $\phi 5.11"$ ($\phi 130\text{mm}$)
 6"Size: $\phi 7.28"$ ($\phi 185\text{mm}$)
 8"Size: $\phi 9.25"$ ($\phi 235\text{mm}$)

Side View

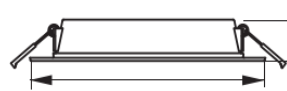

3"Size: 0.85" (21.5mm)
 4"Size: 0.99" (25.3mm)
 6"Size: 1.03" (26.3mm)
 8"Size: 1.07" (27.3mm)

3"Size: $\phi 3.86"$ ($\phi 98\text{mm}$)
 4"Size: $\phi 5.11"$ ($\phi 130\text{mm}$)
 6"Size: $\phi 7.28"$ ($\phi 185\text{mm}$)
 8"Size: $\phi 9.25"$ ($\phi 235\text{mm}$)

4" Square

6" Square

Front View

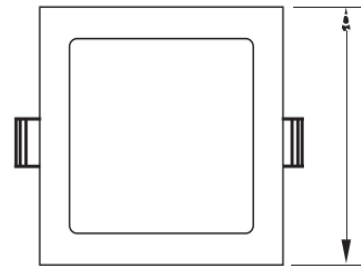

4"Size: 5.03" (128mm)
 6"Size: 6.69" (170mm)

Side View

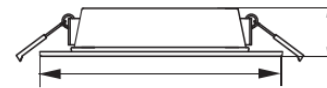

4"Size: 5.03" (128mm)
 6"Size: 6.69" (170mm)

4"Size: 1.03" (26.3mm)
 6"Size: 1.03" (26.3mm)

PHOTOMETRIC REPORT

9W 4" Round LED Ultra Slim Downlight
 LUMINOUS INTENSITY DISTRIBUTION DIAGRAM

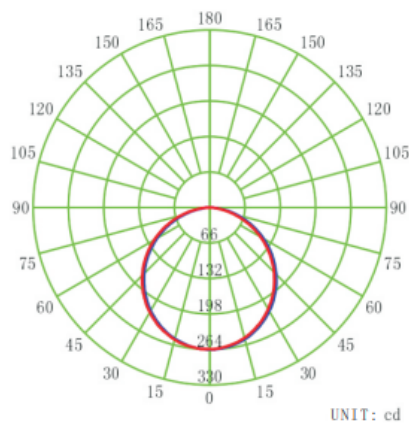

VERTICAL EQUILUMINOUS CURVE

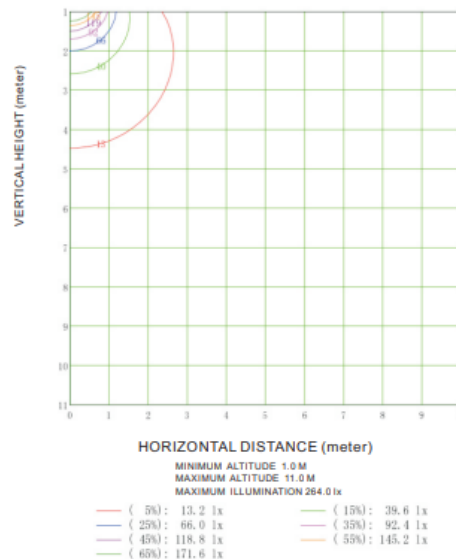



LED Slim Downlight - SDL Series

PACKAGE INFO

Model	HY-SDL-R3-6W-5CCT	HY-SDL-R4-9W-5CCT	HY-SDL-S4-9W-5CCT	HY-SDL-R6-12W-5CCT	HY-SDL-S6-12W-5CCT	HY-SDL-R8-18W-5CCT
Size	3" Round	4" Round	4" Square	6" Round	6" Square	8" Round
Qty/Pack	20 PCS					10 PCS
Package Size	395X265X240mm	395X315X290mm	395X315X290mm	395X415X400mm	395X385X370mm	520X400X260mm
	15.55"X10.4"X9.4"	15.55"X12.4"X11.4"	15.55"X12.4"X11.4"	15.6"X16.3"X15.7"	15.6"X15.1"X14.57"	20.47"X15.8"X10.2"
Package Weight	6.5 kg/14.3 lbs	7.3 kg/16.1 lbs	7.4 kg/16.3 lbs	9.5 kg/21 lbs	9.3 kg/20.5 lbs	6.4 kg/14.11 lbs
Package CBM	0.025122	0.036083	0.036083	0.06557	0.056268	0.05408
40GP Capacity	~46170 PCS	~32140 PCS	~32140 PCS	~17690 PCS	~20610 PCS	~10720 PCS
40HQ Capacity	~54130 PCS	~32140 PCS	~37690 PCS	~20740 PCS	~24170 PCS	~12570 PCS
45HQ Capacity	~62090 PCS	~32140 PCS	~43230 PCS	~23790 PCS	~27720 PCS	~14420 PCS

ORDERIN CODE DEFINITION

Company Code	Product	Shape Size		Watt	CCT
HY	SDL: Ultra-Slim Downlight	R3: Round 3"		6W	5CCT: 2700K/3000K/3500 K/4000K/5000K
		R4: Round 4"	S4: Square 4"	9W	
		R6: Round 6"	S6: Square 6"	12W	
		R8: Round 8		18W	

INSTALLATION PROCEDURE



WARNING:

1. Switch off before installation.
2. Switch on only after complete installation and examination of the circuit.

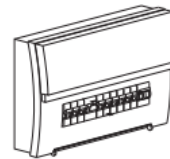

**Turn off
Power Supply**



LED Slim Downlight - SDL Series

WIRING GUIDE

1. Open the hardwire box swing cover and remove one of the knock out holes on the side of the electrical box, based on the installation position.
2. Feed the wires from the electrical source through the open knock out hole in the electrical box
3. Connect black wire to live wire, white wire to neutral wire, and green wire with ground (as shown) and secure using wago connector. Close the cover of the box.

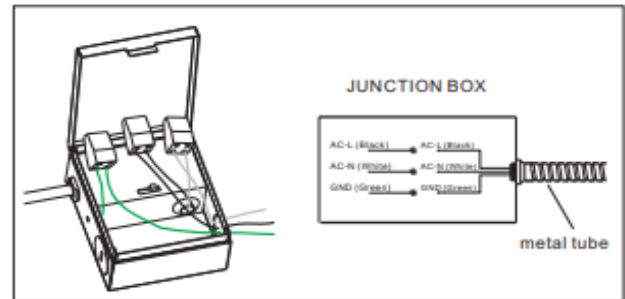

CCT Adjustable

Select color and move the CCT switch. you can change the color temperature to: 2700k/3000k/3500k/4000k/5000k by the CCT switch (If CCT selectable applicable)

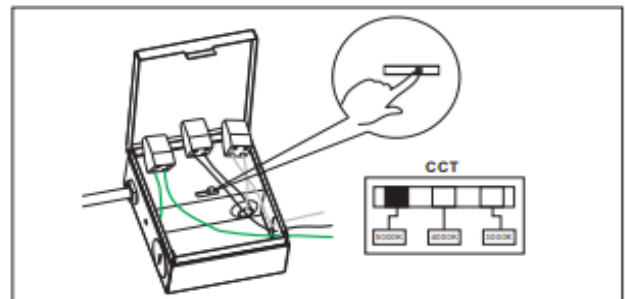

INSTALLATION INSTRUCTION

Installation Preparation

1. Locate a suitable position to plate the fixture and open in accordance to the cut-hole dimensions (refer to Hole Cut Table for appropriate size).
2. Run electrical wire from the switch (power supply) through the mounting hole- use NMD90 Romex or BX cable.

Fixture Installation

1. Positioning the electrical box: Holding the clips, and push the fixture thru the cut-out hole in the ceiling and position it where desired.
2. Connecting the electrical box to the LED Downlight: Connect the remote driver box to the light fixture and Twist the two parts of the connector in opposite directions to lock them together.
3. Push the spring clip on the fixture upward and push the fixture through the ceiling hole and place fixture in the hole. Release the clips and the fixture will be pulled flush to the ceiling, making sure the spring clips are holding securely
4. Turn on the power and make sure your fixture is working properly. If the fixture is not light up in 5 seconds, turn power off, carefully remove the module and double check all wiring and replace.

Ceiling	Hole Cut Size
	3" Round DOWNLIGHT: $\phi 3.15"$ (80mm)
	4" Round DOWNLIGHT: $\phi 4.33"$ (110mm)
	6" Round DOWNLIGHT: $\phi 6.29"$ (160mm)
	8" Round DOWNLIGHT: $\phi 8.15"$ (207mm)
	4" Square DOWNLIGHT: 3.94" X 3.94" (100 X 100mm)
	6" Square DOWNLIGHT: 5.51" X 5.51" (140 X 140mm)

