

Keilton + autani

EFS106 Series

Plug and Play High Bay Sensor



EFS106-BH4
(Lens Sold Separately)



EFS106-AUX
(Lens Sold Separately)



EFS106-Z10
(Lens Sold Separately)

Description

EFS106 low voltage high bay sensors are ideal for Luminaire Level Lighting Control (LLLC/NLC5) applications. Featuring integrated daylight harvesting and PIR motion sensors, the EFS106 sensors are designed for pre-installation in linear high bay or UFO high bay luminaires. EFS106 sensors are equipped with the **AlgoH²** algorithm to maximize detection for high bay applications up to 40 ft without false triggers.

Features

- Plug and Play with sensor port pre-installed
- Bluetooth network technology
- Designed for High Bay applications
- **AlgoH²** algorithm enhances performance in high bay applications
- Built-in analog PIR sensor
- Replaceable lens options
- 12V DC input
- Daylight harvesting available

Requirements

- Lens sold separately
- Requires Dim-to-Off LED drivers with 12V AUX output
- Requires one of the BH4/SC01/Zhaga receptacles

Specifications

Input Voltage	DC 12V
Input Current	50mA Max
Input Power	0.6W
Output Voltage	DC 10V
Output Current	10mA Max
Output Power	0.1W
Dimming	Class 2, 0-10V DC 10mA Max
Sinking Current	10mA Max
Bluetooth Transmit	100ft Max
Radio Frequency	2.4GHz ± 75MHz
Bluetooth Version	4.2/5.0
Housing Material	UL 94-5VA
Detection Range	40-100ft
Mounting Height	20-50ft
Indoor/Outdoor Use	Indoor Use
Operating Temperature	-30°C to 55°C, -22°F to 131°F
Storage Temperature	-30°C to 85°C, -22°F to 185°F
IP Rating	IP40
Color	White, Black
Warranty	5 year warranty
Compliance	UL8750, RoHS

Safety
cULus Listed LED Controller
E504054
FCC ID: 2A26YLTKTVT2021
DID: D057145
DLC: NLTRC5KLOTN

Mating Receptacle (not included in the product package)



Ordering Information - EFS106 Series

Model	BASE	Color	Photocell Type	Bluetooth Version	Description
EFS106-BH4.A0	BH4	White	DLH*	4.2	Plug and Play High Bay Sensor
EFS106-BH4.B1				5	
EFS106-AUX.A0	AUX			4.2	
EFS106-AUX.B1				5	
EFS106-Z10.A0	Zhaga-Z10			4.2	
EFS106-Z10.B1				5	

* DLH = Daylight Harvesting

Ordering Information - Accessories

Model	Type	Description
HBL1-2-W	Lens	High Bay Lens 20ft to 40ft Mounting Height
HBL3-2-W	Lens	High Bay Lens 20ft to 50ft Mounting Height
MBL1-2-W	Lens	Middle Bay Lens
BH4	Base	BH4 Mating Receptacle
SC01	Base	Mating Receptacle
SC03	Base	Turnable Mating Receptacle

Wiring

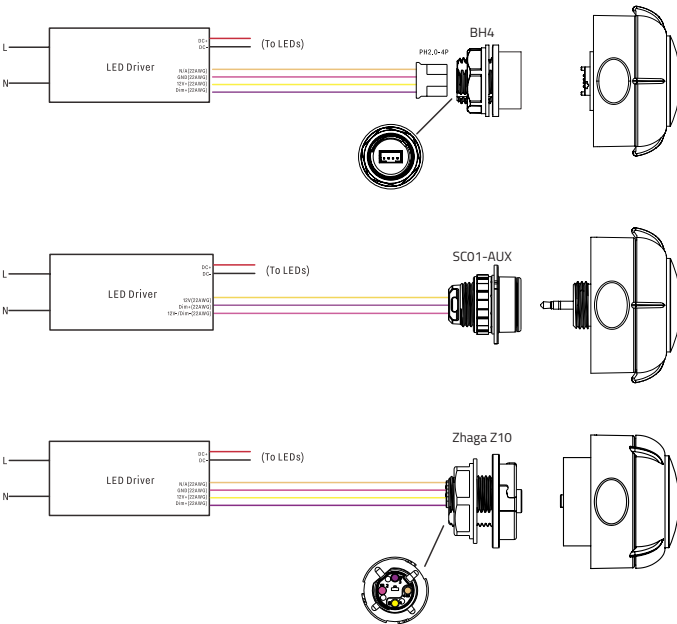

Socket Mounting Dimensions		1/2 inch US standard knockout
Size	T.P.I - inch	Major Dia. - inch
R1/2	14	0.825

Dimensions

Unit:inch/mm

EFS106-BH4

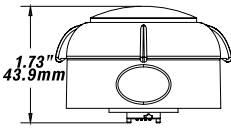

EFS106-AUX

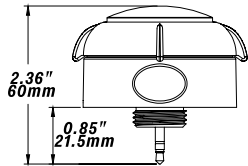

EFS106-Z10

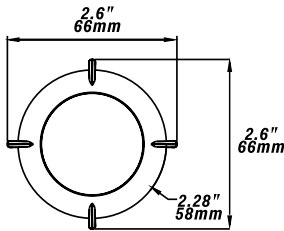
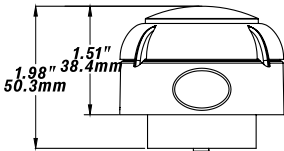

Dimensions - Accessories

BH4

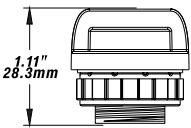

SC01-AUX

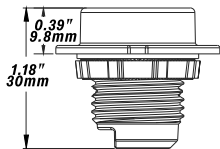

SC03-AUX

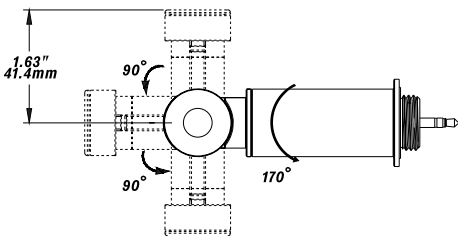
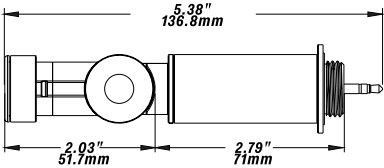

Socket Mounting Dimensions		1/2 inch US standard knockout
Size	T.P.I - inch	Major Dia. - inch
R1/2	14	0.825

Unit:inch/mm

HBL1

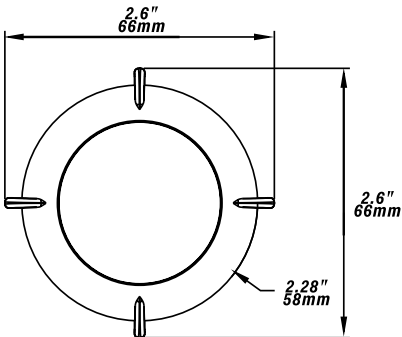
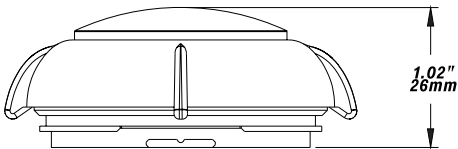

Coverage Side View

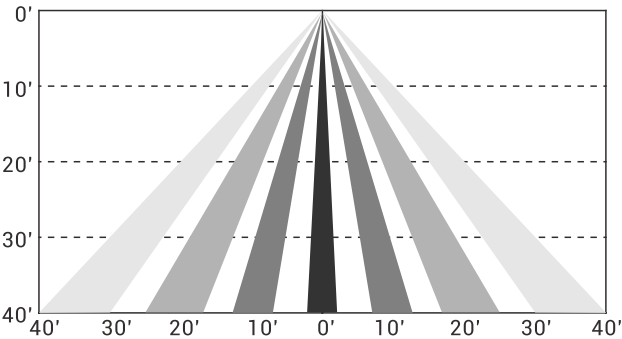

Coverage Top View

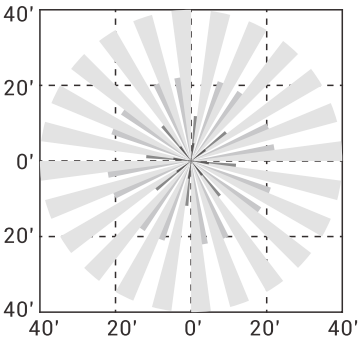

Height 40ft

Dimensions - Accessories

HBL3

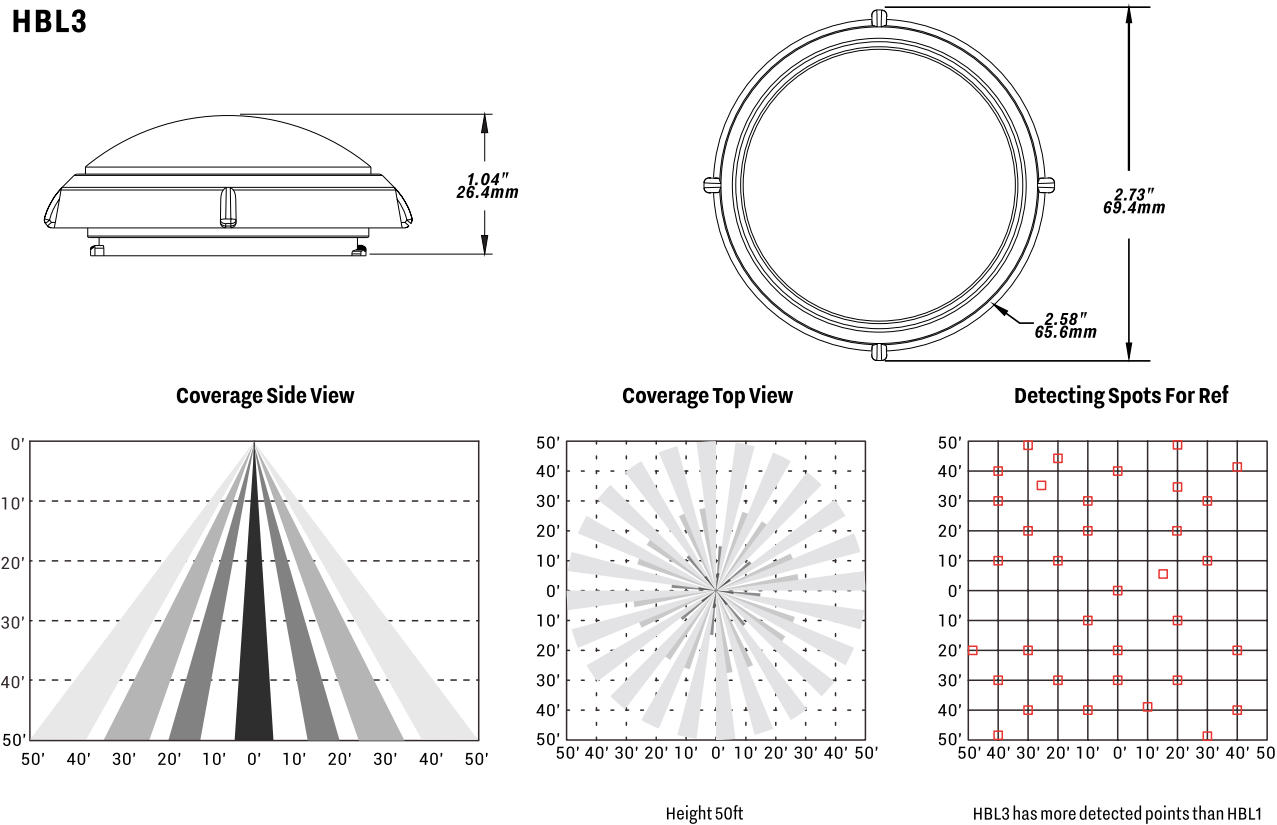

Product Label



App Download



Due to our continued efforts to improve our products, specifications are subject to change without notice.