

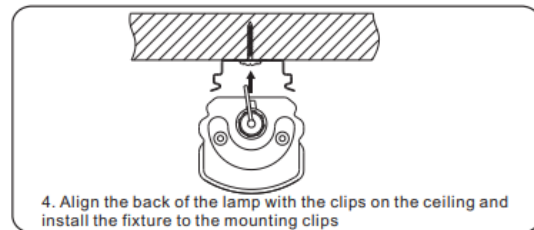

LED TRI-PROOF LIGHT - LV401 Series

INSTALLATION

Surface Mount Installation

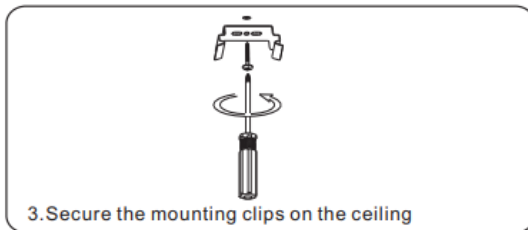
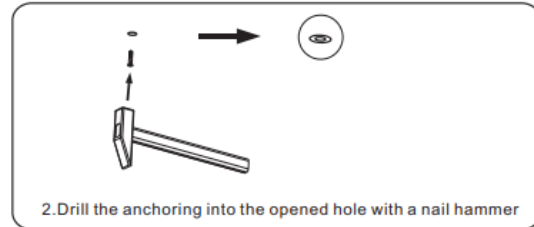
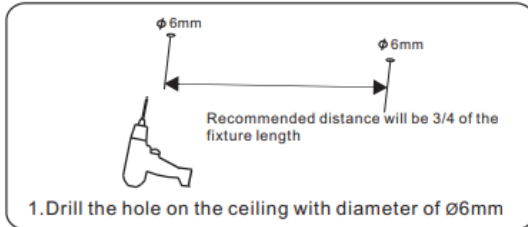

Suspension Installation

B Suspension installation

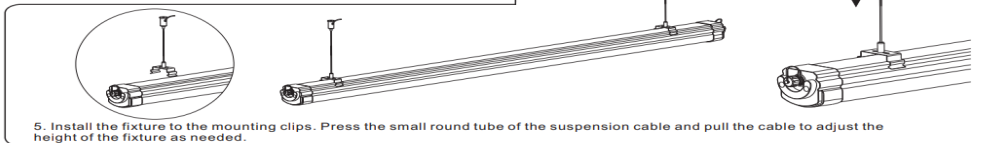
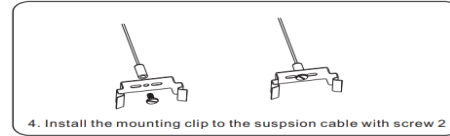
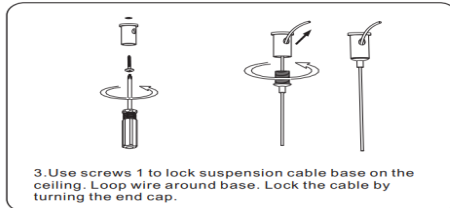
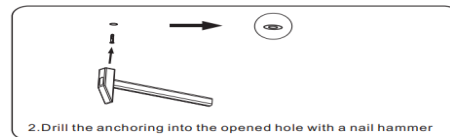
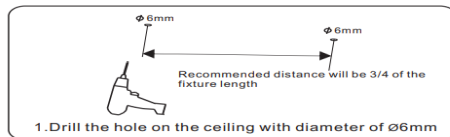

Connection Installation

1 Wiring Guide

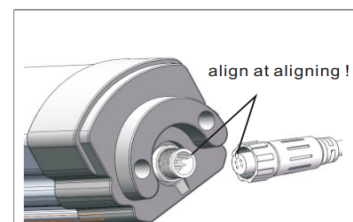
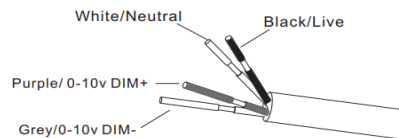

2 Connection Installation

1. Please find the connector in the accessories bag.
2. Plug the connector into the tube.

Note:
 For safety standard,
 please do not connect more than 4pcs 4ft LED lamp in a row;
 do not connect more than 3 pcs 8ft LED lamp in a row.

