

# Specification Sheet & Installation Instruction

## Flange Mount Kit

THIS PRODUCT MUST BE INSTALLED IN ACCORDANCE WITH THE APPLICABLE INSTALLATION CODE BY A PERSON FAMILIAR WITH THE CONSTRUCTION AND OPERATION OF THE PRODUCT AND THE HAZARDS INVOLVED

### PRODUCT DIMENSIONS

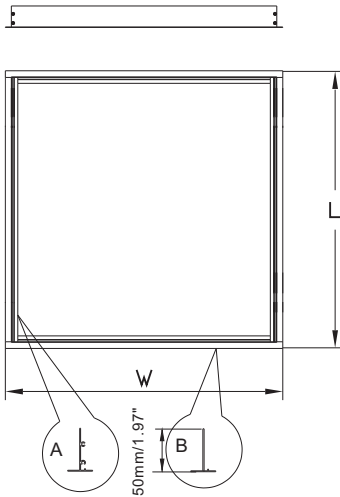

Size	1'X4'	2'X2'	2'X4'
Dimensions	1213X303X(9--45)mm 47.76"X11.93"X(0.35--1.77)"	603X603X(9--45)mm 23.74"X23.74"X(0.35--1.77)"	1213X603X(9--45)mm 47.76"X23.74"X(0.35--1.77)"
L	1257mm/49.49"	647mm/25.47"	1257mm/49.49"
W	347mm/13.66"	647mm/25.47"	647mm/25.47"
A Length of aluminium	1226mm/48.27"	616mm/24.25"	1226mm/48.27"
B Length of aluminium	347mm/13.66"	647mm/25.47"	647mm/25.47"

### INSTALLATION INSTRUCTION

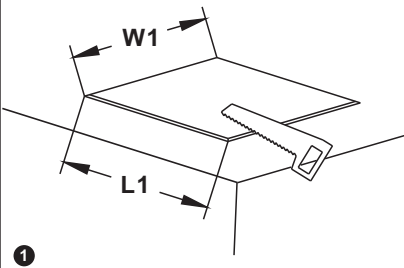

#### Cut-Out Size

Cut holes in the ceiling according to the corresponding size in the table

Size	1'X4'	2'X2'	2'X4'
Hole Cut Dimensions			
L 1	1236mm/48.66"	626mm/24.65"	1236mm/48.66"
W 1	326mm/12.83"	626mm/24.65"	626mm/24.65"

1

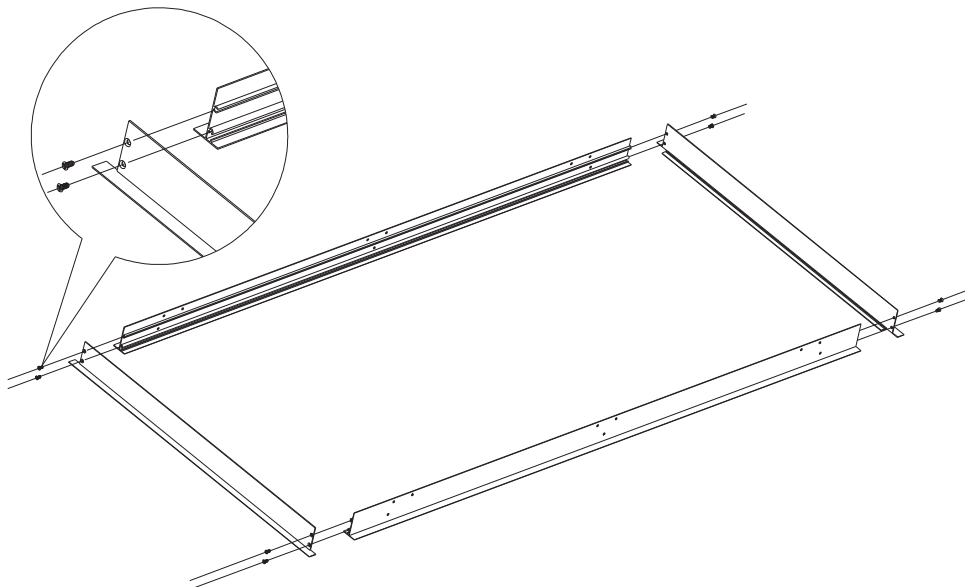

2 Assemble the Recessed Kit with screws

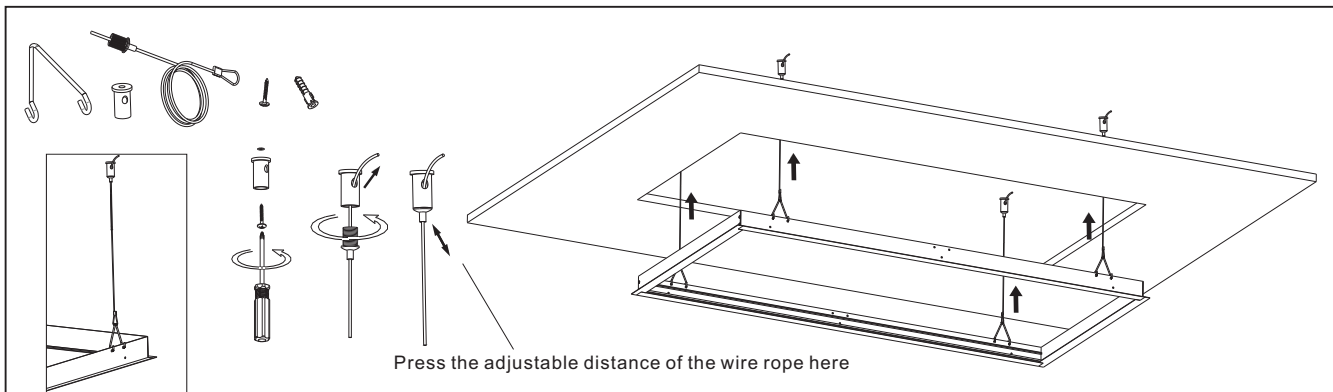

③ Use hooks to hoist the Recessed Kit into the ceiling

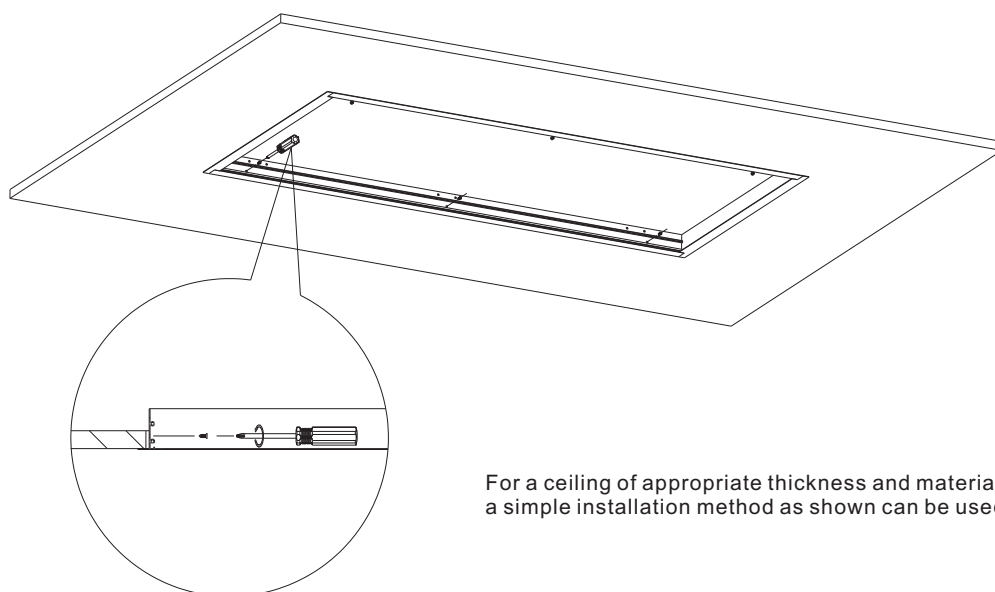
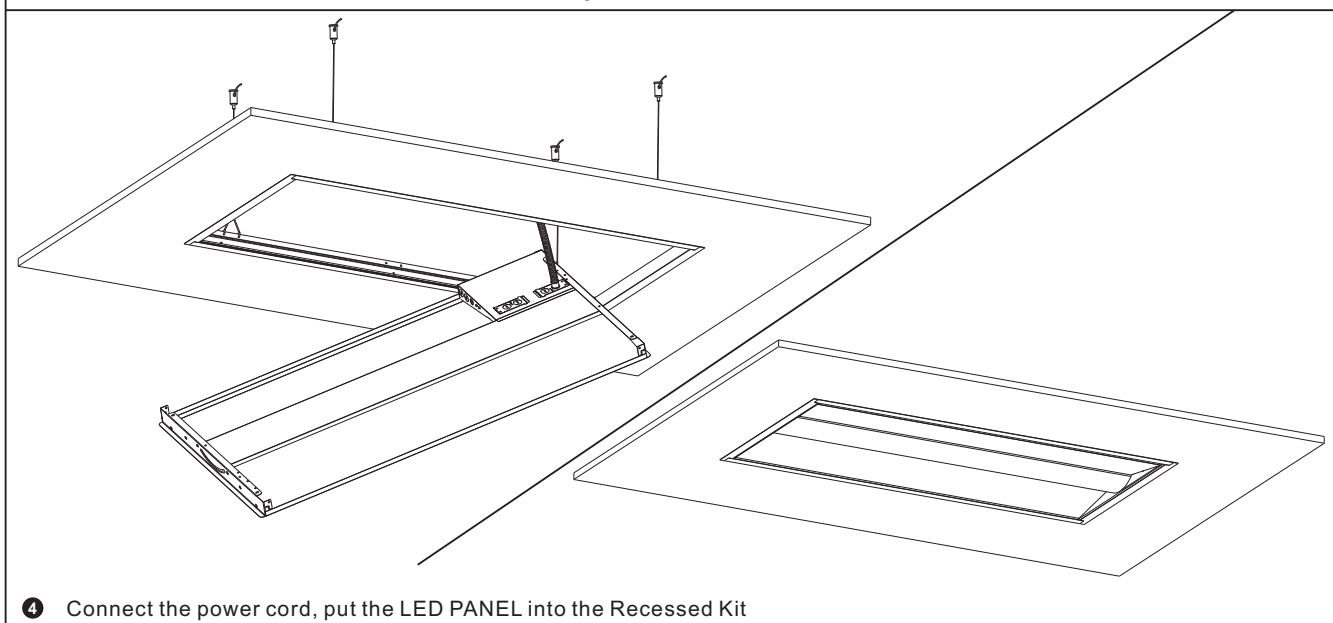

For a ceiling of appropriate thickness and material, a simple installation method as shown can be used

**Note:**

The ceiling used for installing lamps and lanterns must be firm and reliable! in case the lamps fall down!